

D-22A

DIGITAL TRANSMITTER

Code Setting Instructions

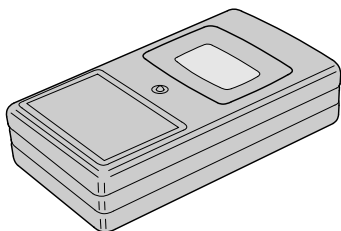

Linear

(619) 438-7000 • FAX (619) 438-7043
USA & Canada (800) 421-1587 & (800) 392-0123
Toll Free FAX (800) 468-1340

STEP 2A Coding for single-channel receivers. Pick any valid combination of OFF/ON codes and set them on switch keys 1-8 in the receiver (or note code already set in receiver if adding to an existing installation). Match the same code on switch keys 1-8 in the transmitter.

CODING SWITCH IN SINGLE CHANNEL RECEIVER

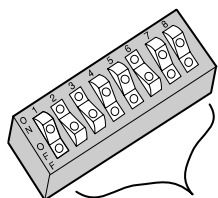

SET KEYS 1-8 TO ANY VALID CODE OR NOTE EXISTING CODE

CODING SWITCH IN D-22A TRANSMITTER

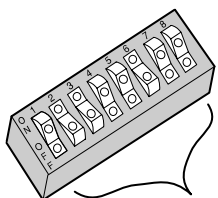

MATCH CODE ON KEYS 1-8

STEP 3 Test the equipment. Connect the receiver to its power source. With relay output receivers, listen for the relay click when the transmitter is activated. A multi-meter can be used to detect activation of relay and solid state output receivers. Operate the transmitter from various locations to determine the radio range.

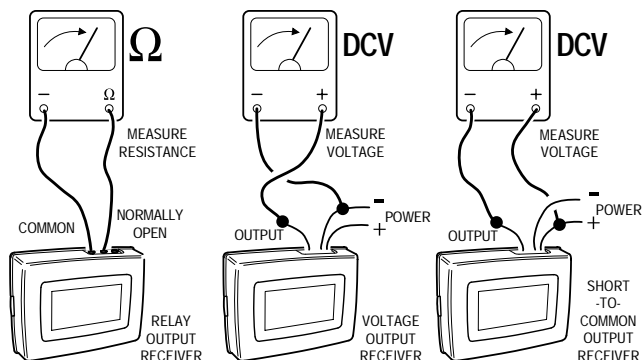

The D-22A is a hand-held digital radio transmitter often called a "Panic Button". The transmitter can perform a variety of remote switching tasks when used with any of Linear's Standard Digital "D" Series Receivers. Typically the D-22A is used in wireless or hybrid wireless/hardwire security systems.

The transmitter is powered by a 9-volt battery. Activate the transmitter by pressing **and holding the pushbutton for at least two seconds**. The red LED on the face of the transmitter will glow as the unit transmits and the receiver with the matching digital code will activate.

The Standard Digital radio format provides 256 different digital codes. The code is set using the 8-position coding switches in the transmitter and receiver.

* **CAUTION: All Standard Digital transmitters and receivers should be recoded prior to installation and operation.**

In order to avoid the possibility of duplicating codes in adjacent systems, factory set codes should not be used. In addition, among the valid codes available, four others should not be used. These include: all keys set ON or OFF and keys set in an alternating ON/OFF or OFF/ON pattern.

The D-22A will transmit as long as the pushbutton is pressed. Depending on conditions (interference, obstacles and distance to the receiver) the receiver output may or may not stay activated for as long as the transmitter is sending a signal.

STEP 2B Coding for two and four-channel receivers. Pick any combination of OFF/ON codes and set them on switch keys 3-8 in the receiver. Match the same code on switch keys 3-8 in the transmitter. Set the transmitter switches 1 & 2 to select the receiver channel that it will activate. **2 & 4-Channel receiver switch keys 1 & 2 are unused and can be set in any position.**

2 OR 4-CHANNEL RECEIVER CODING SWITCH

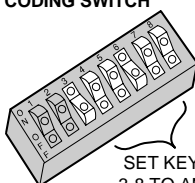

KEYS 1 & 2 IN RECEIVER ARE UNUSED
SET KEYS 3-8 TO ANY VALID CODE

D-22A CODE SWITCH OPTIONS

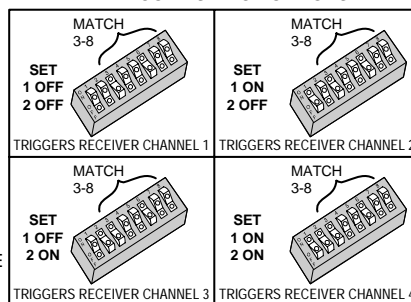

STEP 1 Locate coding switch. Remove the battery access door located on the back of the transmitter case. Identify the coding switch and note that it has eight positions, with ON and OFF clearly marked.

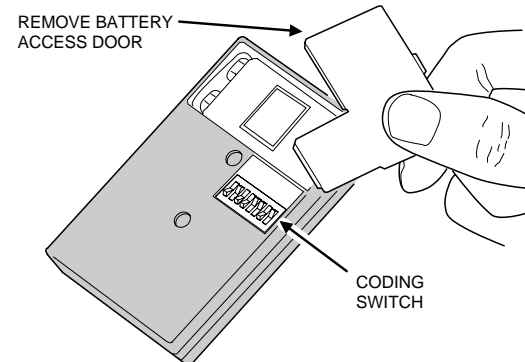

STEP 2C Coding for eight-channel receivers. Pick any combination of OFF/ON codes and set them on switch keys 4-8 in the receiver. Match the same code on switch keys 4-8 in the transmitter. Set the transmitter switches 1, 2 & 3 to select the receiver channel that it will activate. **8-Channel receiver switch keys 1, 2 & 3 are unused and can be set in any position.**

D-22A CODE SWITCH SETTINGS FOR 8-CHANNEL RECEIVERS

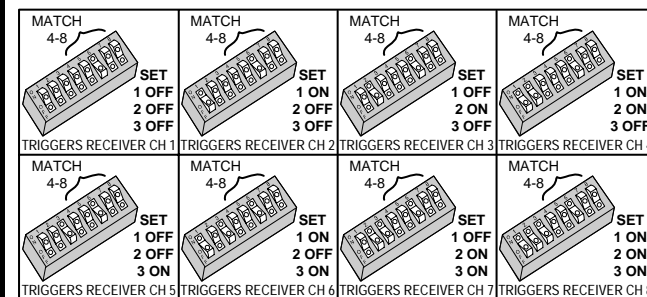

BATTERY REPLACEMENT

The battery should last 12 to 18 months with normal use. When the red LED lights dimly, or not at all when transmitting, the battery needs to be replaced. Remove the battery access door to change the battery. Any type of 9-volt battery can be used. Replace the battery door and foam battery pad when finished.

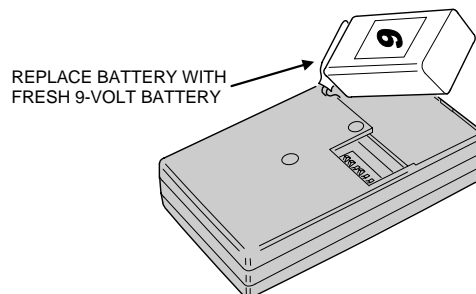

LINEAR LIMITED WARRANTY

This Linear product is warranted against defects in material and workmanship for twelve (12) months. The Warranty Expiration Date is labeled on the product. **This warranty extends only to wholesale customers who buy direct from Linear or through Linear's normal distribution channels. Linear does not warrant this product to consumers.** Consumers should inquire from their selling dealer as to the nature of the dealer's warranty, if any. **There are no obligations or liabilities on the part of Linear Corporation for consequential damages arising out of or in connection with use or performance of this product or other indirect damages with respect to loss of property, revenue, or profit, or cost of removal, installation, or reinstallation.** All implied warranties, including implied warranties for merchantability and implied warranties for fitness, are valid only until Warranty Expiration Date as labeled on the product. **This Linear Corporation Warranty is in lieu of all other warranties express or implied.**

For warranty service on Linear equipment return product, at sender's expense to:
Linear Corporation Repairs Department
2580 Pioneer Avenue, Suite C
Vista, CA 92083

IMPORTANT !!!

Linear radio controls provide a reliable communications link and fill an important need in portable wireless signalling. However, there are some limitations which must be observed.

- * For U.S. installations only: The radios are required to comply with FCC Rules and Regulations as Part 15 devices. As such, they have limited transmitter power and therefore limited range.
- * A receiver cannot respond to more than one transmitted signal at a time and may be blocked by radio signals that occur on or near their operating frequencies, regardless of code settings.
- * Changes or modifications to the device may void FCC compliance.
- * Infrequently used radio links should be tested regularly to protect against undetected interference or fault.
- * A general knowledge of radio and its vagaries should be gained prior to acting as a wholesale distributor or dealer, and these facts should be communicated to the ultimate users.